

Brewing Group Replacement

Jura S-Series

Jura X-90/95

Capresso C3000



This document describes the installation and removal of the brewing unit in the Jura S-series espresso makers and other similar models (S8, S9, S95, X90, X95, and C3000)

IMPORTANT! Make sure the coffeemaker is **UNPLUGGED** from the mains outlet before you start working on it!



Remove the water tank.



Remove the drip tray.



Remove the steam dial by pulling it straight out.

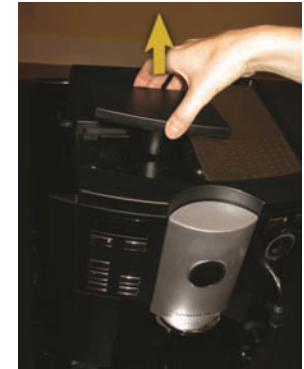

Remove the ground coffee funnel.



Remove the aroma lid and the coarseness dial.

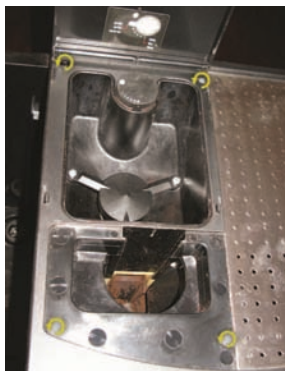

Unscrew the four screws marked with arrows.



Swing up the cup warmer plate and remove it. Then remove the three screws marked with arrows.



Lift the top straight up. Please observe that the clip marked with the blue arrow is now loose. You may want to put it aside so that it is not lost (very important if you intend to vacuum the interior).



Unscrew the screw marked with the arrow. Carefully lift up the two clips marked by the blue arrows and pull the steam assembly in the direction of the yellow arrow so that it unlatches.

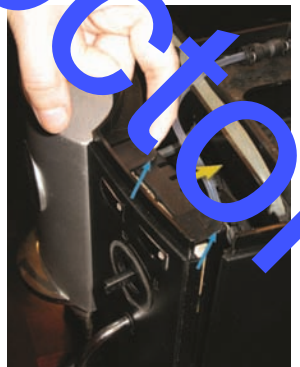

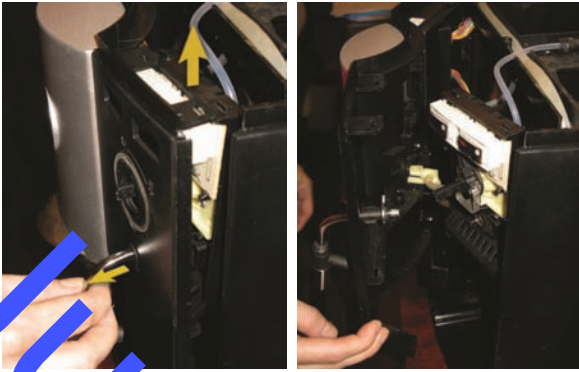

Push back the steam tube to release it from the steam assembly. Now the bottom of the steam assembly can be accessed by lifting upwards and you can open up the front door about half-way.

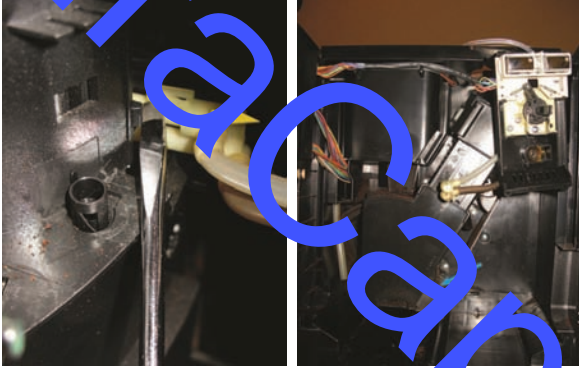

Carefully use a screwdriver to unclamp the hose connector. Now the hose can be fully opened and you finally get access to the brewing group. The next step is to disconnect the inner hose (see arrow).

©2009 Peter Nielsen (peter@pmview.com). All Rights Reserved.

- 5 -

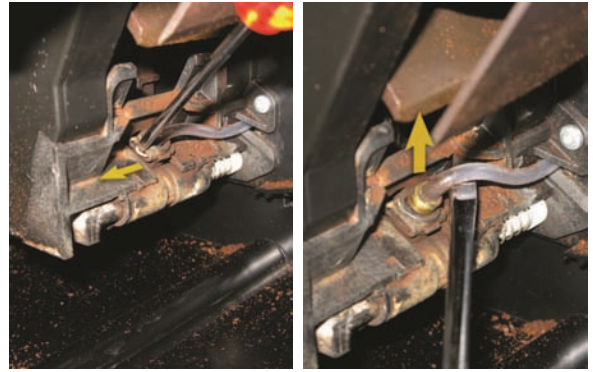

Use a screwdriver or needle nose pliers to remove the hose locking clip. Then carefully pull out the hose. (Some machine models use a black L-connector to avoid the sharp tube bend).

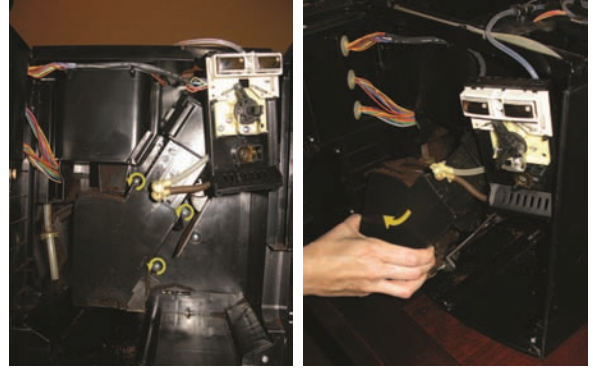

Unscrew the three screws marked with arrows. Once screws are removed, carefully lift out the brewing unit by swinging out the bottom. NOTE: There's still a hose that needs to be disconnected.

©2009 Peter Nielsen (peter@pmview.com). All Rights Reserved.

- 6 -

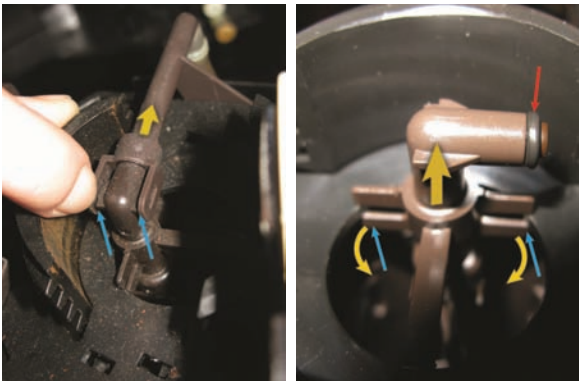

Unclip the two retainers so that they unclamp and pull the tube in the direction of the arrow (left picture). After this, verify that the O-ring sits on the L-connector (red arrow). It's probably stuck in the counter-piece. Use a small screwdriver or paper clip to fish it out and place it on the L-connector as pictured.

Now your brewing group should be fully removed. Now, please look back at the hose removal on page 6. Does the tube you pulled out have a black O-ring installed? If not, again use a small screwdriver or paper clip to fish it out of the old brewing unit and reinstall it on the hose in the machine.

The next step is to remove the L-connector and transfer it to the new brewing group. Very gently bend the two flaps indicated with the blue arrow in the right hand picture above. This will release the L-connector and let you transfer it to the new brewing group.

©2009 Peter Nielsen (peter@pmview.com). All Rights Reserved.

- 7 -



Remove the transport assembly from the brewing group. It simply slides out.

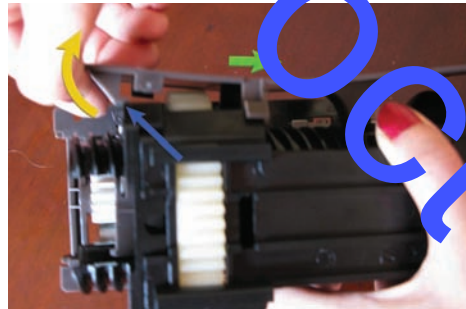

Remove the grounds scoop. Carefully bend the scoop in the direction of the curved arrow so that the tabs (blue arrow) disengage. Once you have done this, the scoop will simply slide off in the direction indicated by the green arrow.

Now you don't need the old brewing unit anymore. Put it aside.

Install the grounds scoop on the new brewing unit. Start by attaching the scoop like in the picture above. Make sure that the lower tabs are properly inserted in the groove (blue arrow). After this, carefully bend the scoop in the direction of the curved arrow so that the tabs can be lifted and pushed back over the edge of the black plastic and engage.

©2009 Peter Nielsen (peter@pmview.com). All Rights Reserved.

- 8 -

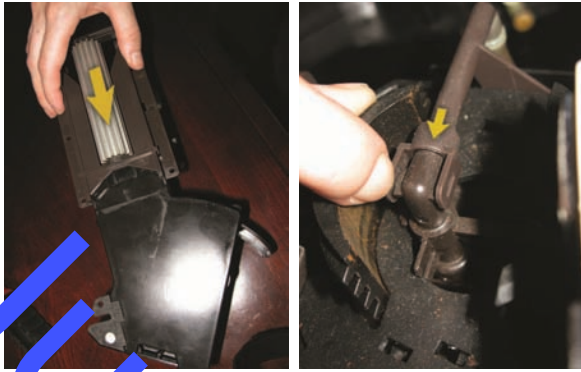

Then slide the support on your new unit with the arrow shaped end first (left picture). After this, reattach the hose to the connector on the top of the brewing unit (right picture).

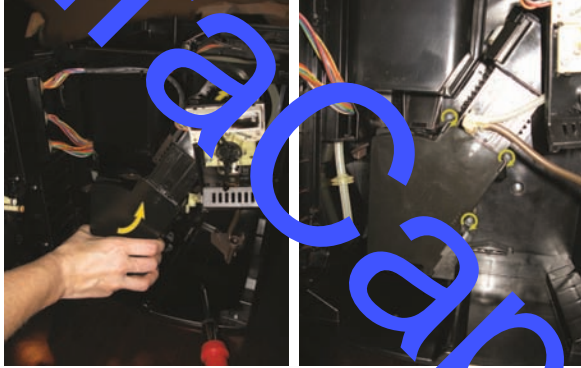

Now insert the brewing group with the top end first and then swing the bottom part. Then the three screws.

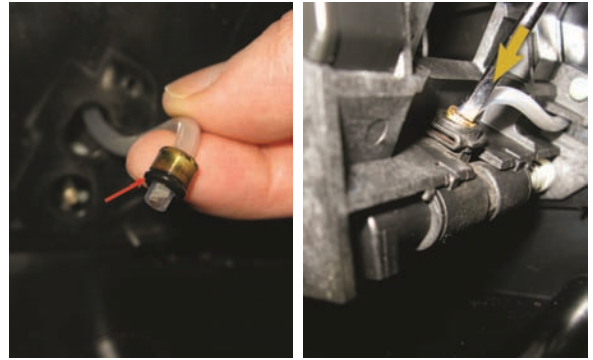

Now attach the tube to the brewing group. Make sure the O-ring gasket is present. Use a small screwdriver to press the hose in the hole. Be careful not to damage the hose! (If you're in luck, your machine has a black L-connector. This makes the whole procedure a lot easier). If you accidentally pull the hose back, you need to pull it out all the way and check the O-ring still is in place!

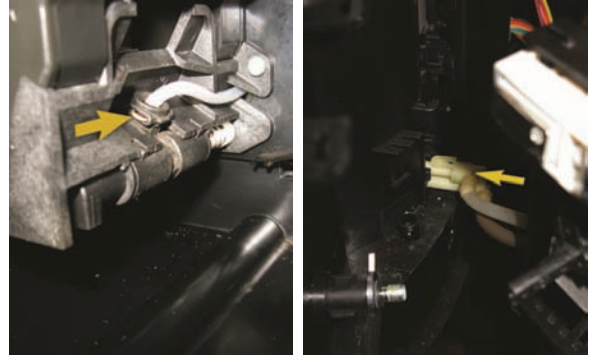

Reinstall the locking clip (left picture). It should easily slide in. If it doesn't, then the hose is not properly seated. Don't try to force the clip in! Reattach the front door hose connector (right picture).

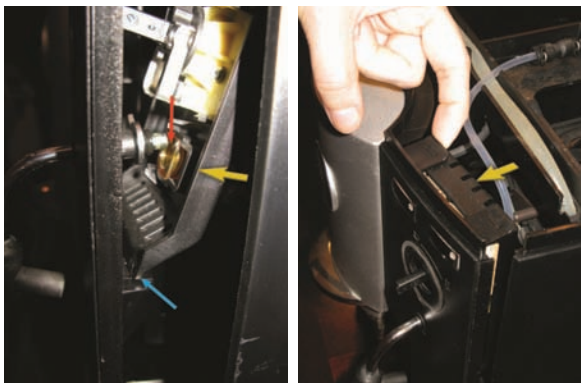

Insert the steam assembly in the two lower tabs (blue arrow). Then align the steam tube with the amber connector (red arrow) and push the assembly together until the latches lock (yellow arrows).

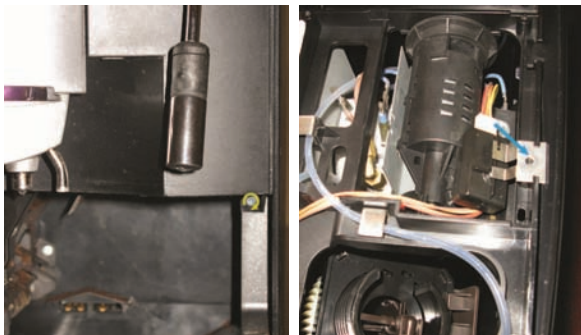

Fasten the front door screw. CAREFUL! DO NOT OVERTIGHTEN THIS SCREW! The thin plastic cracks easily. Once there is no gap or no door play, it is tight enough (left picture).

Make sure that the encoder retaining clip is in place (blue arrow, right picture).

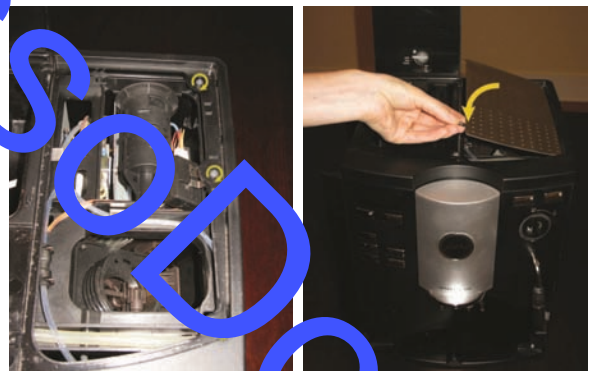

Seat the top cover and fasten the three screws. Seat the top warmer plate.

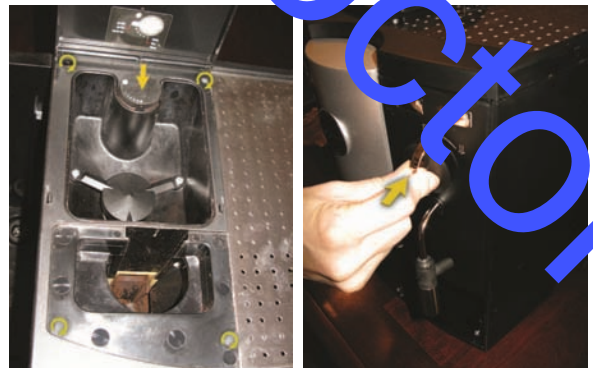

Fasten the four screws and seat the coarseness dial (left picture).

Seat the steam dial. Note that it will only fit one way although this may not be obvious (right picture).



Slide the aroma

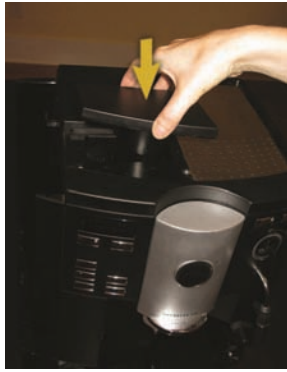

Install the coffee funnel.



Install drip tray.



Install water tank.

DONE!

SurgeCapressoDoctor